



ORI-315M

295-315Watt

Monocrystalline Solar Module



Features
High power output module conversion efficiency with stable cell production technology.

Anti-reflective and anti-soiling surface reduces power loss from dirt and dust.

Outstanding performance in low-light irradiance environments.

Certified to withstand: wind load and snow load.

High salt mist and ammonia resistance certified by TUV Rheinland.

Quality and Safety
Designed according to and complying with all requirements in IEC 61730 , IEC 61215, UL1703, CEC Listed, MCS and CE.

ISO 9001:2008:Quality management systems.
ISO 14001:2004:Environmental management systems.
BS OHSAS 18001:2007:Occupational health and safety management systems.



Warranties

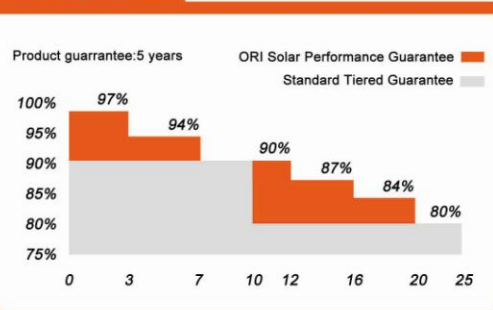

ORI-315M

Electrical Characteristics

Model	ORI-295M	ORI-300M	ORI-305M	ORI-310M	ORI-315MP
Optimum Operating Voltage (Vmp)	36.8V	37.0V	37.2V	37.4V	37.6V
Optimum Operating Current (Imp)	8.02A	8.11A	8.20A	8.29A	8.38A
Open-Circuit Voltage (Voc)	45.3V	45.5V	45.7V	45.9V	46.1V
Short-Circuit Current (Isc)	8.55A	8.64A	8.72A	8.80A	8.87A
Maximum Power at STC (Pmax)	250Wp	255Wp	260Wp	265Wp	270Wp
Module Efficiency	15.20%	15.46%	15.72%	15.98%	16.23%
Operating Temperature	-40°C to +85°C				
Maximum System Voltage	1000V DC (IEC)				
Maximum Series Fuse Rating	15A				
Power Tolerance	0~+3%				

General Characteristics

Solar Cell	Mono-crystalline 156×156mm (6 inches)
Number of Cells	72 (6×12) in series connection
Dimension	1650×992×40mm (77.01×39.05×1.57 inches)
Weight	26.5kgs(58.4 lbs)
Front Glass	4.0mm, High transmission, Low Iron, Tempered
Frame	Anodized aluminum alloy
Mechanical load	5400 pa
Classification	safety class II; Application class A; IP67 rated

Temperature Coefficients

NOCT (°C)	45±2
Temperature Coefficient of Pmax (%/°C)	-0.40
Temperature Coefficient of Voc (%/°C)	-0.29
Temperature Coefficient of Isc (%/°C)	0.05

Packing Solution

Container	40' GP
Pieces per pallet	50
Pallets per container	11
Pieces per container	550

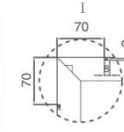

IV Curves

Current-Voltage & Power-Voltage Curves (295W)

